



18,795

2000 I-30 E
Greenville, TX 75402

FILED FOR RECORD
at 2:00 o'clock P M
MAY 14 2024
BECKY LANDRUM
County Clerk, Hunt County, Tex.
By

Friday, April 19, 2024

County: Hunt County

Farmers Electric Cooperative Member: CHRIS BOLL
Service Order Number: 2023124861

Greetings:

Farmers Electric Cooperative, Inc. is requesting permission to construct electrical power distribution facilities which will cross County Road 2646 AT POLE 020846 WHICH IS 2272' N OF SUE ELLEN RD.

Site location map/construction sketches are attached. The construction sketch details the proposed work. The proposed electrical service will be constructed:

- Overhead - All road crossings will have a minimum vertical clearance of 22 feet.
- Underground - All underground bore crossings are PVC encased 4' of coverage from the lowest point of the Right of Way.

If you have any questions, please contact me at any time.

Sincerely,

Psalm Harper
pharper@farmerselectric.coop
Engineering Coordinator

Enclosures

County Approval Section:

Approved: _____ Denied: _____

Authorized Signature: _____ Date: _____

14.4KV

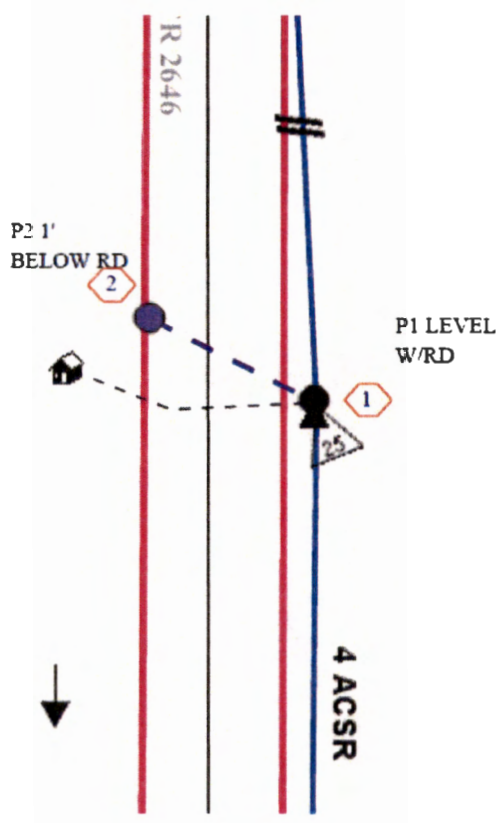

P2 IS 22' FROM CR 2646
AND 2272' FROM SUE ELLEN DR

150ft

